

Data sheet

Float switch brass design 21

Type: SSM...21...

Device with temperature sensor or temperature switch combinable,
see also level / temperature measurement technology combined

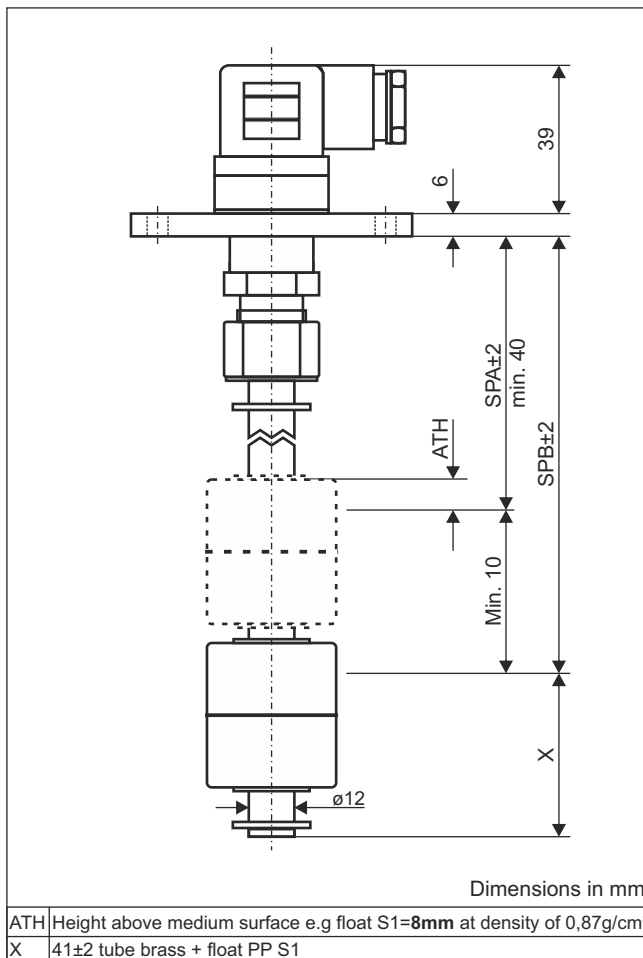

Drilling pattern

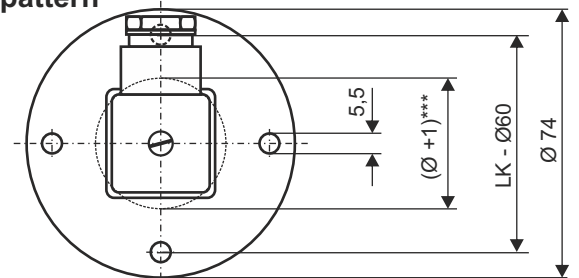

***float through hole, see float-diameter Ø

Order key

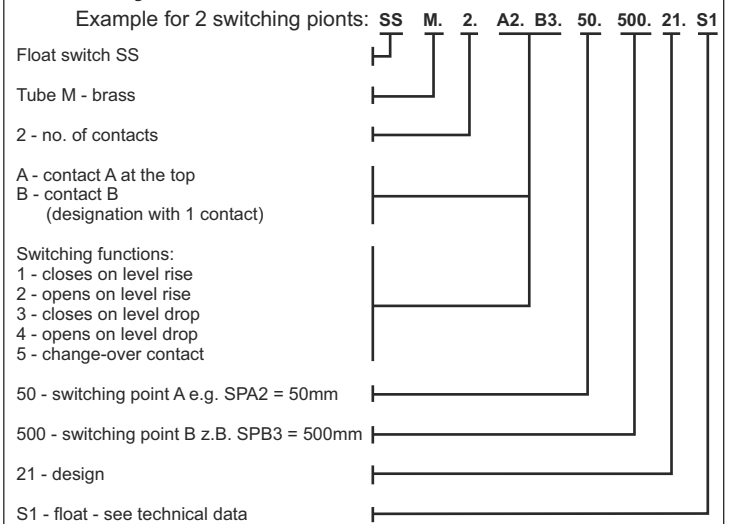

Example for terminal diagrams

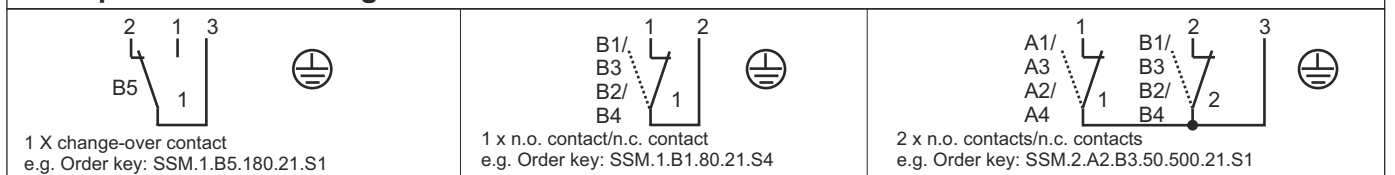

Technical data

Connection:	right-angled plug-type connector 3-pole + PE, DIN EN 175301-803 (DIN 43650), material PA
Mounting:	flange Ø74mm, material alu
Seal:	material NBR
Tube:	Ø12mm, material brass
Float:	Ø35x40mm, material PP, type S1 Ø40x40mm, material PP, type S2 Ø40x30mm, material PP, type S3 Ø45x52mm, material stainless steel 1.4571, type S4
Switching points:	reed contacte, max. 2x n.o. contacts/ n.c. contacts or 1x change-over contact,
Switching capacity:	230 VAC / 1A / 60VA or 100VDC / 1A / 60W
Pressure:	max. 1 bar
Operating temperature:	-20°C to 80°C in medium, -20°C to 70°C above mounting
Protection rating:	IP 65