

Data sheet

Float switch brass design 81 in combination with temperature switch

Type: SSM...81...T

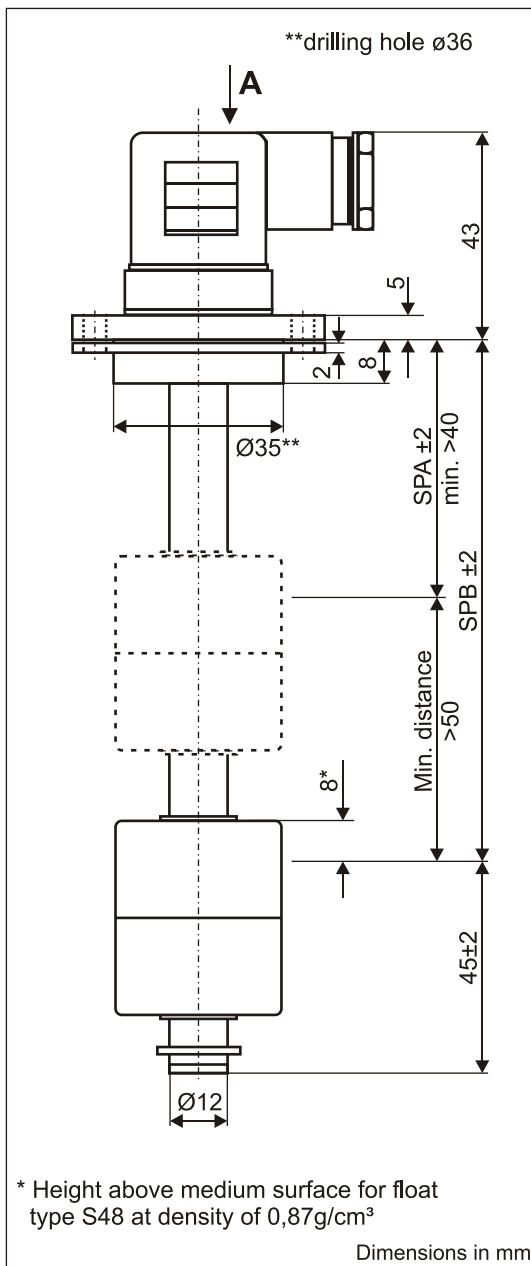

View A

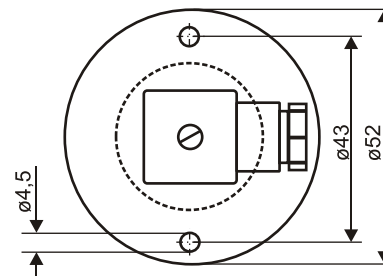

Examples for terminal diagrams

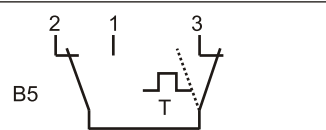

1 x change-over contact + temp. switch
e.g. Order key:
SSM.1.B5.180.81.S1.T60S

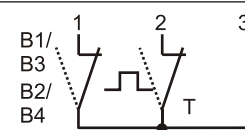

1x n.o. contact/n.c. contact + temp. switch
e.g. Order key:
SSM.1.B3.200.81.S1.T70S

Order key

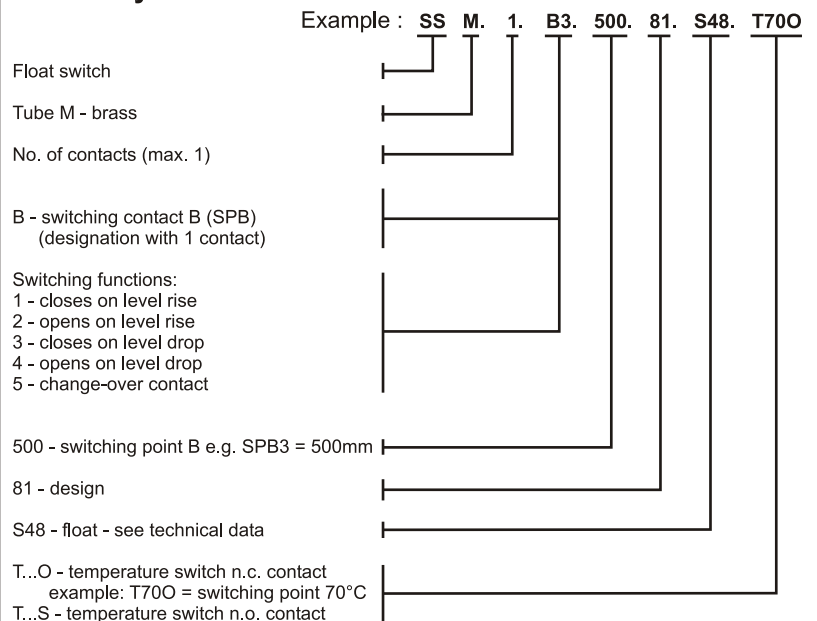

Technical data

Connection:	plug-type connector 3-pole + PE, DIN EN 175301-803 (DIN 43650), material PA
Mounting:	round-flange OD $\varnothing 52$ mm, height 13mm, material alu
Seal:	material NBR
Tube:	$\varnothing 12$ mm, material brass
Float:	$\varnothing 35 \times 40$ mm, material PP, type S48
Switching points:	reed contacts, max. 1x n.o. contact/n.c. contact or 1x change-over contact
Temperature switch:	bi-metal, switching function: n.o. contact/n.c. contact temperature range: 60°C to 140°C precision: $\pm 5^\circ\text{C}$, smaller tolerances on request reset-temperature: temp.-switching point $-30^\circ\text{C} \pm 15^\circ\text{C}$
Switching voltage, current, capacity:	230 VAC, 1A, 60VA
Pressure:	1 bar
Operating temperature:	-20°C to 80°C in medium; -20°C to 70°C above mounting
Protection rating:	IP 65