

# Data sheet

## Conductive level measurement for electrical conductive liquids

### Type: KEE-1...

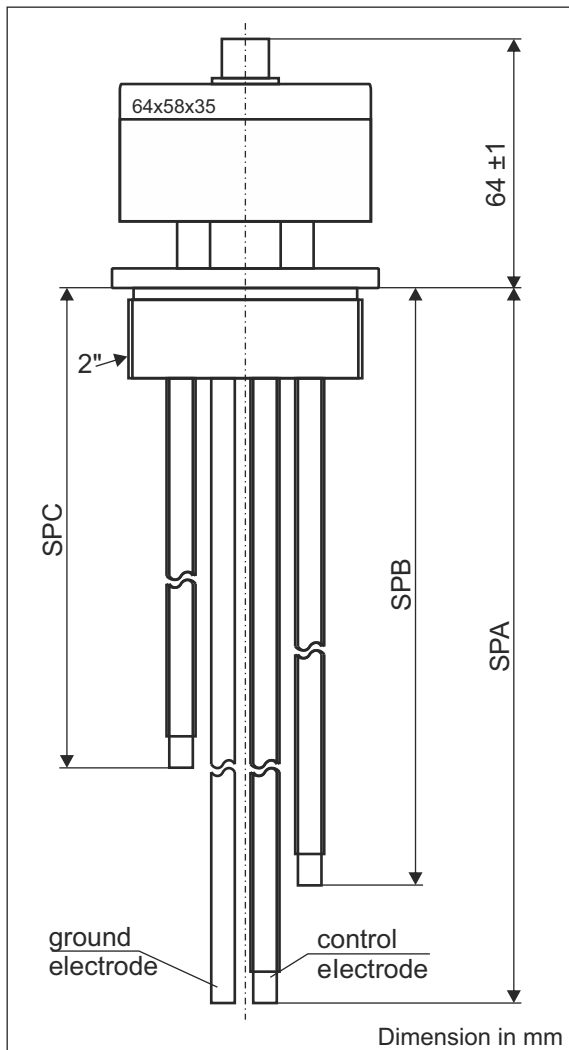

**View A**

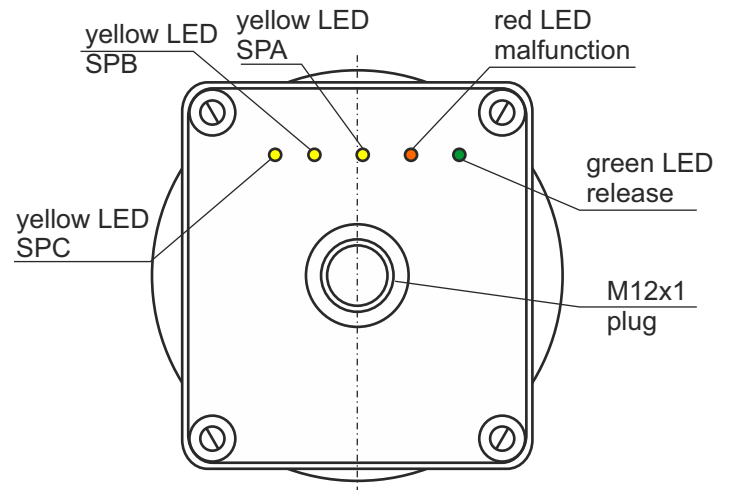

## Example terminal diagram

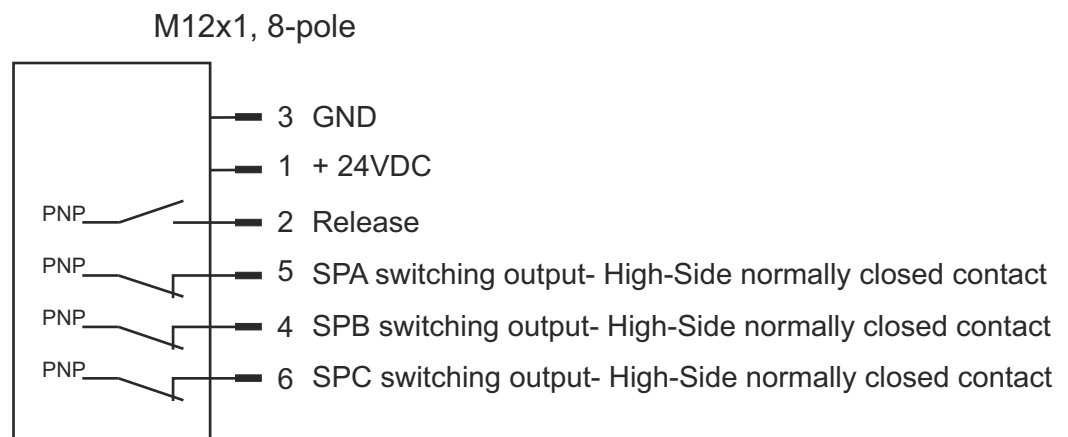

# Data sheet

## Conductive level measurement for electrical conductive liquids

### Type: KEE-1...

#### Order key

Example: KEE-1. AS01. BE26. SE01. Me03. SPA =200. SPB =150. SPC =100. SI08

Type

#### Electrical connection

M12, 4 pole plug AS01  
 M12, 5 pole plug AS23  
 M12, 8 pole plug AS05

#### Mounting

Round flange PP OD100 PCD85 BE56  
 Thread 1" PP BE25  
 Thread 1 1/2" PP BE26  
 Thread 2" PP BE09

#### Control electrode

Stainless steel, polyolefin insulation SE01  
 Stainless steel without insulation SE02

#### Ground electrode

Stainless steel without insulation ME03

#### Level switching points SP... = switching points in mm (length control electrode)

SPA - 1. switching point bottom, opens on level rise = 200\*

SPB - 2. switching point, opens on level rise = 150\*

SPC - 3. switching point, opens on level rise = 100\*

\*Specification in mm

#### Output function

contact, High Side, sensor/actuator conform - SI08

**Accessories: 5pole, 8pole connector sockets. Alternative socket with ready-made cable**

#### Technical data

Connection:	plug-type connector M12x1, 4-, 5- or 8-pole, 2x 4-pole, material TPU
Mounting:	flange mounting OD100 mm, PCD85 mm, material PP or thread 1" to 2" material PP, other mountings on request
Display:	1x green: Release 1x red : Error 3x yellow : switching points A and B
Operating mode display:	release switches on after initialization and switches off at error
Fault detection:	short circuit at > 30 mS/cm
Fault detection with blinking code:	1x = short circuit Ref. - electrode 2x = short circuit SPB - electrode 3x = short circuit SPA - electrode 4x = SPA - defect of electrode 5x = REF. - defect of electrode 6x = SPB - defect of electrode
Electrode material:	stainless steel 1.4571 other material on request
Electrode insulation:	polyolefin hose, other material on request
Electrode length:	as per customer specification, in conformity with the switching points
Ground connection:	via ground electrode
Medium conductivity:	100 µS/cm to 10 mS/cm
Output:	3x n. c. contact and 1x n. o. contact High - Side, 24 VDC / 0.5 A
Switching point:	max. 3, SPA, SPB, SPC
Measuring signal:	5 Vss, 1.7KHz
Integration time:	0.5 seconds, fixed setting
Supply voltage:	24 VDC ± 15%
Pressure:	max. 1 bar
Operating temperature:	-20°C to 80°C in medium, -20°C to 70°C above mounting
Protection rating:	IP65

*Subject to change*